

EMAUX P50 Plastic Spa Light

B) INSTALLATION

- 1) Punch or drill a hole (Diameter = 62mm) in the desired location on the pool wall, see Figure 1. Be sure the top of the hole be at least 18 inches below the water level.
- 2) Put a O-ring on the pool wall and then feed the cord through the hole.
- 3) Use the nut provided to fix the underwater light on the pool wall, as shown in Figure 2.

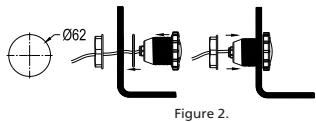

Figure 2.

- 4) Feed cord to junction box, strip 6 inches of the outer cord jacket to expose the insulation wires and make the wire connection to the junction box.
- 5) Secure the junction box cover in place.
- 6) Before operating the light

for more than 10 seconds, fill the pool with water until the underwater light is completely submerged in water. To check for proper operation, turn on main switch or circuit breaker as well as the switch that operates the underwater light itself.

⚠ WARNING

A) Never operate this Underwater Light for more than 10 seconds unless it is totally submerged in water. Without total submersion, the light assembly will get extremely hot, which may result in serious injury to pool users, installers, or damage to property.

B) Be sure power is off before installing or removing lamp. Allow lamp to cool before relamping. This light fixture uses a Halogen Quartz lamp. Do Not touch lamp with bare hand, this may severely reduce its life. Use the plastic furnished with the replacement lamp to eliminate finger prints from getting on lamp.

Repair Parts list for Plastic Spa Light

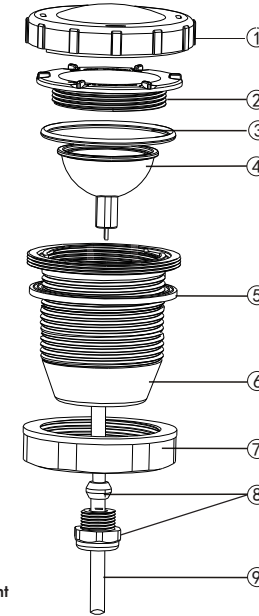

Figure 3 – Repair Parts Illustration for Plastic Spa Light

Repair Parts list for Plastic Spa Light

Key No.	Part No.	Description	Qty
1*	01221001	P50 Light Colour Lens (Red+Green+Blue)	1
1*	01221001C	UL-P50 Light Colour Lens (Clear)	1
2	01041019	Inside Covers for P50 Lights	1
3	02021010	O-Ring	1
4	04011001	Halogen lamp MR16 AC 12V/20W for UL-P50	1
4	04011016	LED-P50 lamp 12V/1W (Automatic Colour-Changing)	1
4	04011015	LED-P50 lamp 12V/1W (White Colour Only)	1
5	02021000	O-ring for Encasing	2
6	89041101	P50 Lights Encasing Set	1
7	01021007	Nut	1
8	89041102	Connector with Gasket for Cable	1
9	04013001	Lights Cable 1.5M for P50	1

Notes: 1* 01221001 is UL-P50 Light Colour Len 1 set with (Red+Greee+Blue) or 1* 01221001C is UL-P50 Light Colour Len with (Clear)